

GOVAL
I T A L Y 

Flanges Technical C a t a l o g

Catálogo Técnico Flanges

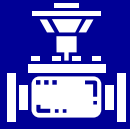



GOVAL
I T A L Y 

MANUFACTURING & DISTRIBUTOR



GOVAL ITALY S.r.L

GOVAL ITALY established in 2009, a fast-growing company based in Milano Italy, specializes in the supply of valves, pipes, and pipe fittings to variety of industries such as Gas & Oil and Water.

Our policy is to provide high end products sourced from quality assessed manufacturers, whose products meet the EU standards.

Furthermore, we operate internationally and exports products to customers overseas. We make sure that we provide a streamlined process for all of our clients.

Our business model enables manufacturers to have full access to global trade, empowering them to focus on their core markets. We provide our retail partners with high demand products and offer direct to customer fulfillment to help build their extended aisle assortments.

Why US:

Privileges to work with us:

- We stock all of our products in warehouse located in Milano industrial area. We are ready to ship and fulfill your immediate needs.
- We carry a very wide range of valves, pipes and fittings, covering a wide range of corporate needs.
- We are constantly revamping logistics and supply chain processes, so as to keep costs down and our prices competitive.

Our Mission

We adopt the latest technology to guarantee excellent quality and services.

Our Vision

To make a difference through providing the technical solutions that appropriate to every customer's needs.

DIN 2631 Welding Neck Flanges
 DIN 2573 Slip-on Flanges
 DIN 2527 Blind Flanges
Nominal Pressure 6

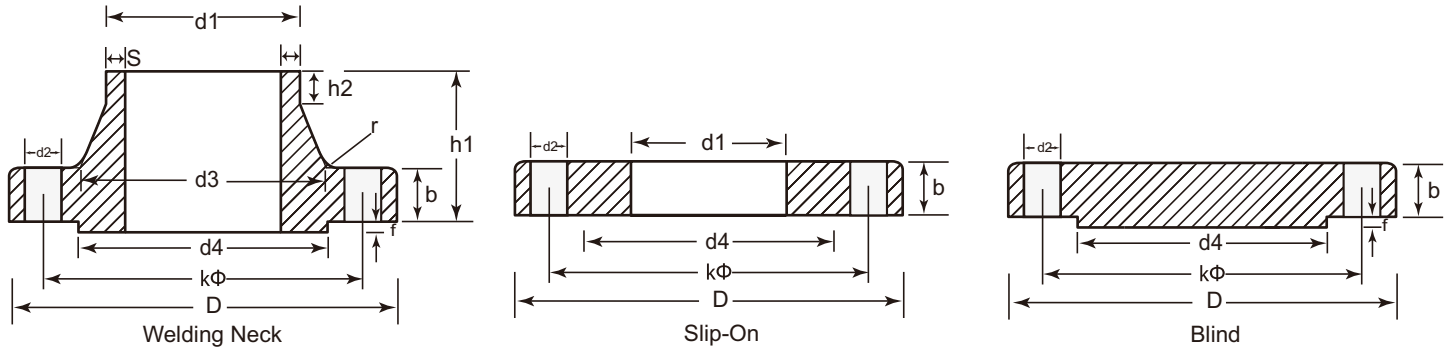

Unit: mm

| Pipe | | Flange | | | | | Neck | | | | Raised Face | | Bolts | | | Arropx. Weight (kg) | | | |
|------|---------------------------------|--------|-----------------|---------|-------|-----|----------------|--------------------------------|-----|----|----------------|----------------|-------|----|--------------|---------------------|----------------------|-------------|-------|
| DN | d ₁ DIN (ISO)* | D | b | | | k | h ₁ | d ₃ DIN (ISO) | s | r | h ₂ | d ₄ | f | # | Dia. of Bolt | d ₂ | Weld- ing Nack | Slip- on | Blind |
| | | | Welding Nack | Slip-on | Blind | | | | | | | | | | | | | | |
| 10 | 14 (17.2) | 75 | 12 | 12 | 12 | 50 | 28 | 22 (26) | 1.8 | 4 | 6 | 35 | 2 | 4 | M10 | - 11.5 | 0.34 | 0.36 | 0.33 |
| 15 | 20 (21.3) | 80 | 12 | 12 | 12 | 55 | 30 | 28 (30) | 2 | 4 | 6 | 40 | 2 | 4 | M10 | - 11.5 | 0.39 | 0.41 | 0.38 |
| 20 | 25 (26.9) | 90 | 14 | 14 | 14 | 65 | 32 | 35 (38) | 2.3 | 4 | 6 | 50 | 2 | 4 | M10 | - 11.5 | 0.59 | 0.60 | 0.59 |
| 25 | 30 (33.7) | 100 | 14 | 14 | 14 | 75 | 35 | 40 (42) | 2.6 | 4 | 6 | 60 | 2 | 4 | M10 | - 11.5 | 0.75 | 0.74 | 0.74 |
| 32 | 38 (42.4) | 120 | 14 | 16 | 14 | 90 | 35 | 50 (55) | 2.6 | 6 | 6 | 70 | 2 | 4 | M12 | 1/2 " 14 | 1.05 | 1.19 | 1.07 |
| 40 | 44.5 (48.3) | 130 | 14 | 16 | 14 | 100 | 38 | 58 (62) | 2.6 | 6 | 7 | 80 | 3 | 4 | M12 | 1/2 " 14 | 1.18 | 1.39 | 1.21 |
| 50 | 57 (60.3) | 140 | 14 | 16 | 14 | 110 | 38 | 70 (74) | 2.9 | 6 | 8 | 90 | 3 | 4 | M12 | 1/2 " 14 | 1.34 | 1.53 | 1.43 |
| 65 | 76.1 | 160 | 14 | 16 | 14 | 130 | 38 | 88 | 2.9 | 6 | 9 | 110 | 3 | 4 | M12 | 1/2 " 14 | 1.67 | 1.89 | 2.21 |
| 80 | 88.9 | 190 | 16 | 18 | 16 | 150 | 42 | 102 | 3.2 | 8 | 10 | 128 | 3 | 4 | M16 | 5/8 " 18 | 2.71 | 2.98 | 3.09 |
| 100 | 108 (114) | 210 | 16 | 18 | 16 | 170 | 45 | 122 (130) | 3.6 | 8 | 10 | 148 | 3 | 4 | M16 | 5/8 " 18 | 3.24 | 3.46 | 4.37 |
| 125 | 133 (139) | 240 | 18 | 20 | 18 | 200 | 48 | 148 (155) | 4 | 8 | 10 | 178 | 3 | 8 | M16 | 5/8 " 18 | 4.49 | 4.60 | 5.68 |
| 150 | 159 (168) | 265 | 18 | 20 | 18 | 225 | 48 | 172 (184) | 4.5 | 10 | 12 | 202 | 3 | 8 | M16 | 5/8 " 18 | 5.15 | 5.22 | 7.02 |
| 200 | 216 (219) | 320 | 20 | 22 | 20 | 280 | 55 | 230 (236) | 5.9 | 10 | 15 | 258 | 3 | 8 | M16 | 5/8 " 18 | 7.78 | 7.15 | 11.7 |
| 250 | 267 (273) | 375 | 22 | 24 | 22 | 335 | 60 | 282 (290) | 6.3 | 12 | 15 | 312 | 3 | 12 | M16 | 5/8 " 18 | 10.8 | 9.61 | 17.6 |
| 300 | 318 (323) | 440 | 22 | 24 | 22 | 395 | 62 | 335 (342) | 7.1 | 12 | 15 | 365 | 4 | 12 | M20 | 3/4 " 23 | 14.0 | 12.6 | 24.0 |
| 350 | 368 (355) | 490 | 22 | 26 | 22 | 445 | 62 | 385 | 7.1 | 12 | 15 | 415 | 4 | 12 | M29 | 3/4 " 23 | 16.5 | 15.6 | 30.1 |
| 400 | 419 (406) | 540 | 22 | 26 | 22 | 495 | 65 | 438 | 7.1 | 12 | 15 | 465 | 4 | 16 | M20 | 3/4 " 23 | 18.7 | 18.4 | 36.4 |
| 500 | 521 (508) | 645 | 24 | 30 | 24 | 600 | 68 | 538 | 7.1 | 12 | 15 | 570 | 4 | 20 | M20 | 3/4 " 23 | 28.6 | 24.5 | 58.1 |
| 600 | 622 (609) | 755 | 24 | - | - | 705 | 70 | 640 | 7.1 | 12 | 16 | 670 | 5 | 20 | M24 | 7/8 " 27 | 31.5 | - | - |

* NOTE: Outside diameter of pipe complies with ISO recommendation R64.

DIN 2632 Welding Neck Flanges
 DIN 2576 Slip-on Flanges
 DIN 2527 Blind Flanges
Nominal Pressure 10

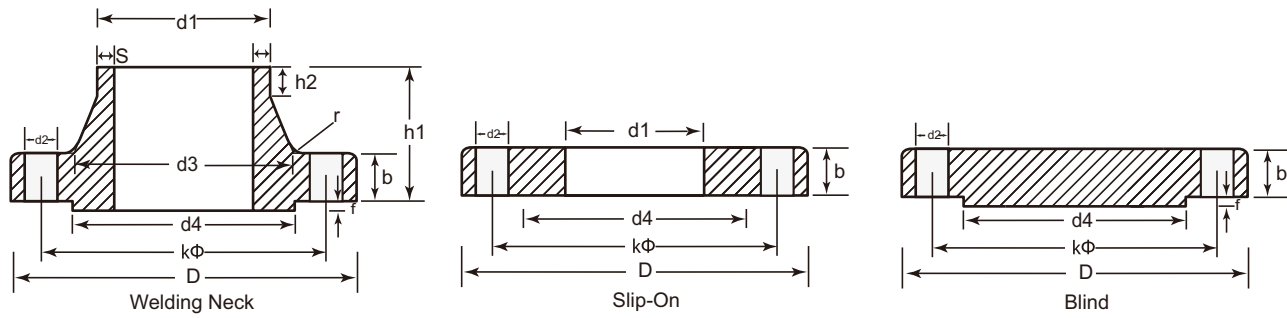

Unit: mm

| Pipe | | Flange | | | | | Neck | | | Raised Face | | Bolts | | | Arropx. Weight (kg) | | | | | |
|------|---------------------------------|--------|----------------------|--------------|------------|-----|----------------|--------------------------------|-----|-------------|----------------|----------------|---|----|---------------------|----------------|----------------------|--------------|-------|------|
| DN | d ₁ DIN (ISO)* | D | b Welding Nack | b Slip-on | b Blind | k | h ₁ | d ₃ DIN (ISO) | s | r | h ₂ | d ₄ | f | # | Dia. of Bolt | d ₂ | Weld- ing Nack | Slip- on | Blind | |
| 10 | 14 (17.2) | 90 | 14 | 14 | 14 | 60 | 35 | 25 (28) | 1.8 | 4 | 6 | 40 | 2 | 4 | M12 | 1/2 | " 14 | 0.58 | 0.61 | 0.56 |
| 15 | 20 (21.3) | 95 | 14 | 14 | 14 | 65 | 35 | 30 (32) | 2 | 4 | 6 | 45 | 2 | 4 | M12 | 1/2 " | 14 | 0.65 | 0.68 | 0.64 |
| 20 | 25 (26.9) | 105 | 16 | 16 | 16 | 75 | 38 | 38 (40) | 2.3 | 4 | 6 | 58 | 2 | 4 | M12 | 1/2 | " 14 | 0.95 | 0.95 | 0.93 |
| 25 | 30 (33.7) | 115 | 16 | 16 | 16 | 85 | 38 | 42 (45) | 2.6 | 4 | 6 | 68 | 2 | 4 | M12 | 1/2 " | 14 | 1.14 | 1.14 | 1.13 |
| 32 | 38 (42.4) | 140 | 16 | 16 | 16 | 100 | 40 | 52 (56) | 2.6 | 6 | 6 | 78 | 2 | 4 | M16 | 5/8 | " 18 | 1.69 | 1.66 | 1.66 |
| 40 | 44.5 (48.3) | 150 | 16 | 16 | 16 | 110 | 42 | 60 (64) | 2.6 | 6 | 7 | 88 | 3 | 4 | M16 | 5/8 " | 18 | 1.86 | 1.89 | 1.85 |
| 50 | 57 (60.3) | 165 | 18 | 18 | 18 | 125 | 45 | 72 (75) | 2.9 | 6 | 8 | 102 | 3 | 4 | M16 | 5/8 | " 18 | 2.53 | 2.51 | 2.59 |
| 65 | 76.1 | 185 | 18 | 18 | 18 | 145 | 45 | 90 | 2.9 | 6 | 10 | 122 | 3 | 4 | M16 | 5/8 " | 18 | 3.06 | 3.00 | 3.33 |
| 80 | 88.9 | 200 | 20 | 20 | 20 | 160 | 50 | 105 | 3.2 | 8 | 10 | 138 | 3 | 8 | M16 | 5/8 | " 18 | 3.70 | 3.79 | 4.34 |
| 100 | 108 (114) | 220 | 20 | 20 | 20 | 180 | 52 | 125 (131) | 3.6 | 8 | 12 | 158 | 3 | 8 | M16 | 5/8 " | 18 | 4.62 | 4.20 | 5.26 |
| 125 | 133 (139) | 250 | 22 | 22 | 22 | 210 | 55 | 150 (156) | 4 | 8 | 12 | 188 | 3 | 8 | M16 | 5/8 | " 18 | 6.30 | 5.71 | 7.67 |
| 150 | 159 (168) | 285 | 22 | 22 | 22 | 240 | 55 | 175 (184) | 4.5 | 10 | 12 | 212 | 3 | 8 | M20 | 3/4 " | 23 | 7.75 | 6.72 | 9.85 |
| 200 | 216 (219) | 340 | 24 | 24 | 24 | 295 | 62 | 235 | 5.9 | 10 | 16 | 268 | 3 | 8 | M20 | 3/4 | " 23 | 11.3 | 9.50 | 15.6 |
| 250 | 267 (273) | 395 | 26 | 26 | 26 | 350 | 68 | 285 (292) | 6.3 | 12 | 16 | 320 | 3 | 12 | M20 | 3/4 " | 23 | 14.7 | 12.5 | 23.1 |
| 300 | 318 (323) | 445 | 26 | 26 | 28 | 400 | 68 | 344 | 7.1 | 12 | 16 | 370 | 4 | 12 | M20 | 3/4 | " 23 | 17.6 | 14.4 | 29.4 |
| 350 | 368 (355) | 505 | 26 | 28 | 30 | 460 | 68 | 385 | 7.1 | 12 | 16 | 430 | 4 | 16 | M20 | 3/4 " | 23 | 21.4 23.4 | 20.6 | 38.0 |
| 400 | 419 (406) | 565 | 26 | 32 | 32 | 515 | 72 | 440 | 7.1 | 12 | 16 | 482 | 4 | 16 | M24 | 7/8 | " 27 | 26.1 28.7 | 27.9 | 47.5 |
| 500 | 521 (508) | 670 | 28 | 38 | 34 | 620 | 75 | 542 | 7.1 | 12 | 16 | 585 | 4 | 20 | M24 | 7/8 " | 27 | 38 | 41.1 | 72.7 |
| 600 | 622 (609) | 780 | 28 | - | - | 725 | 80 | 642 | 7.1 | 12 | 18 | 685 | 5 | 20 | M27 | 1 | " 30 | 44.2 | - | - |

* NOTE: Outside diameter of pipe complies with ISO recommendation R64 .

DIN 2634 Welding Neck Flanges
 DIN 2544 Slip-on Flanges
 DIN 2527 Blind Flanges
Nominal Pressure 25

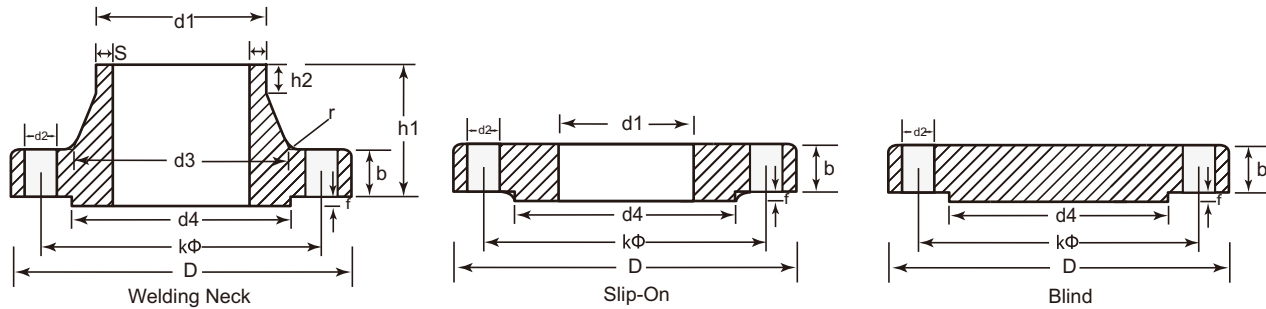

Unit: mm

| Pipe | | Flange | | | | Neck | | | | Raised Face | | Bolts | | | Arropx. Weight (kg) | | | | | |
|------|---------------------------------|--------|-----------------|---------|-------|------|----------------|--------------------------------|-----|-------------|----------------|----------------|---|----|---------------------|----------------|----------------------|--------------|-------|------|
| DN | d ₁ DIN (ISO)* | D | b | | | k | h ₁ | d ₃ DIN (ISO) | s | r | h ₂ | d ₄ | f | # | Dia. of Bolt | d ₂ | Weld- ing Nack | Slip- on | Blind | |
| | | | Welding Nack | Slip-on | Blind | | | | | | | | | | | | | | | |
| 10 | 14 (17.2) | 90 | 16 | - | 16 | 60 | 35 | 25 (28) | 1.8 | 4 | 6 | 40 | 2 | 4 | M12 | 1/2 | " 14 | 0.66 | 0.72 | 0.62 |
| 15 | 20 (21.3) | 95 | 16 | 16 | 16 | 65 | 38 | 30 (32) | 2 | 4 | 6 | 45 | 2 | 4 | M12 | 1/2 | " 14 | 0.76 | 0.81 | 0.74 |
| 20 | 25 (26.9) | 105 | 18 | 18 | 18 | 75 | 40 | 38 (40) | 2.3 | 4 | 6 | 58 | 2 | 4 | M12 | 1/2 | " 14 | 1.06 | 1.24 | 1.05 |
| 25 | 30 (33.7) | 115 | 18 | 18 | 18 | 85 | 40 | 42 (45) | 2.6 | 4 | 6 | 68 | 2 | 4 | M12 | 1/2 | " 14 | 1.3 | 1.38 | 1.31 |
| 32 | 38 (42.4) | 140 | 18 | 18 | 18 | 100 | 42 | 52 (56) | 2.6 | 6 | 6 | 78 | 2 | 4 | M16 | 5/8 | " 18 | 1.88 | 2.03 | 1.82 |
| 40 | 44.5 (48.3) | 150 | 18 | 18 | 18 | 110 | 45 | 60 (64) | 2.6 | 6 | 7 | 88 | 3 | 4 | M16 | 5/8 | " 18 | 2.33 | 2.35 | 2.11 |
| 50 | 57 (60.3) | 165 | 20 | 20 | 20 | 125 | 48 | 72 (75) | 2.9 | 6 | 8 | 102 | 3 | 4 | M16 | 5/8 | " 18 | 2.82 | 3.20 | 2.91 |
| 65 | 76.1 | 185 | 22 | 22 | 22 | 145 | 52 | 90 | 2.9 | 6 | 10 | 122 | 3 | 8 | M16 | 5/8 | " 18 | 3.74 | 4.29 | 4.13 |
| 80 | 88.9 | 200 | 24 | 24 | 24 | 160 | 58 | 105 | 3.2 | 8 | 12 | 138 | 3 | 8 | M16 | 5/8 | " 18 | 4.75 | 5.88 | 5.21 |
| 100 | 108 (114) | 235 | 24 | 24 | 24 | 190 | 65 | 128 (134) | 3.6 | 8 | 12 | 162 | 3 | 8 | M20 | 3/4 | " 23 | 6.52 | 7.54 | 7.08 |
| 125 | 133 (139) | 270 | 26 | 26 | 26 | 220 | 68 | 155 (162) | 4 | 8 | 12 | 188 | 3 | 8 | M24 | 7/8 | " 27 | 9.07 | 10.8 | 10.4 |
| 150 | 159 (168) | 300 | 28 | 28 | 28 | 250 | 75 | 182 (192) | 4.5 | 10 | 12 | 218 | 3 | 8 | M24 | 7/8 | " 27 | 11.8 | 14.5 | 13.9 |
| 200 | 216 (219) | 360 | 30 | 30 | 30 | 310 | 80 | 244 | 6.3 | 10 | 16 | 278 | 3 | 12 | M24 | 7/8 | " 27 | 17 | 22.3 | 21.5 |
| 250 | 267 (273) | 425 | 32 | 32 | 32 | 370 | 88 | 292 (298) | 7.1 | 12 | 18 | 335 | 3 | 12 | M27 | 1 | " 30 | 24.4 | 33.5 | 32.5 |
| 300 | 318 (323) | 485 | 34 | 34 | 34 | 430 | 92 | 352 | 8 | 12 | 18 | 395 | 4 | 16 | M27 | 1 | " 30 | 31.2 | 46.3 | 44.7 |
| 350 | 368 (355) | 555 | 38 | 38 | 38 | 490 | 100 | 398 | 8 | 12 | 20 | 450 | 4 | 16 | M30 | 1-1/8 | " 33 | 44.2 47.2 | 68.0 | 65.9 |
| 400 | 419 (406) | 620 | 40 | 40 | 40 | 550 | 110 | 452 | 8.8 | 12 | 20 | 505 | 4 | 16 | M33 | 1-1/4 | " 36 | 58 62 | 89.7 | 87.0 |
| 500 | 521 (508) | 730 | 44 | 44 | 44 | 660 | 125 | 558 | 10 | 12 | 20 | 615 | 4 | 20 | M33 | 1-1/4 | " 36 | 89.6 | 138 | 134 |

* NOTE: Outside diameter of pipe complies with ISO recommendation R64 .

DIN 2635 Welding Neck Flanges
 DIN 2545 Slip-on Flanges
 DIN 2527 Blind Flanges
Nominal Pressure 40

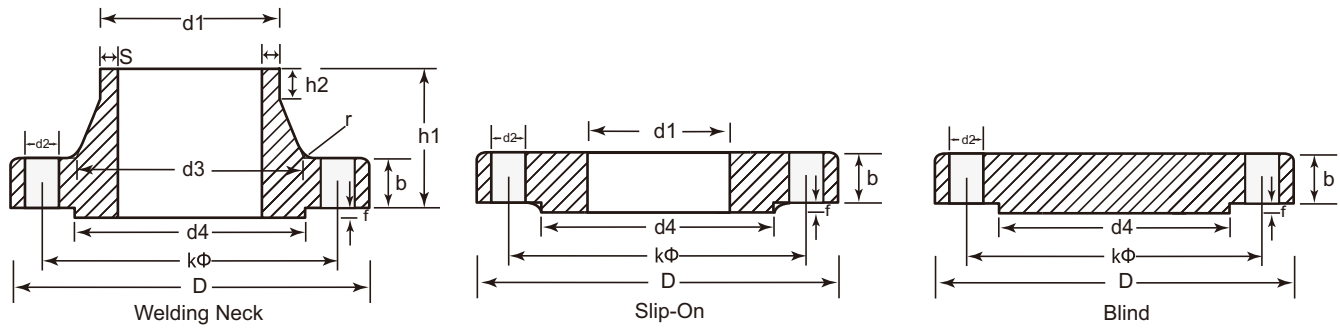

Unit: mm

| Pipe | | Flange | | | | | Neck | | | | Raised Face | | Bolts | | | Arropx. Weight (kg) | | | | |
|------|---------------------------------|--------|-----------------|---------|-------|-----|----------------|--------------------------------|------|----|----------------|----------------|-------|----|--------------|---------------------|----------------------|-------------|-------|------|
| DN | d ₁ DIN (ISO)* | D | b | | | k | h ₁ | d ₃ DIN (ISO) | s | r | h ₂ | d ₄ | f | # | Dia. of Bolt | d ₂ | Weld- ing Nack | Slip- on | Blind | |
| | | | Welding Nack | Slip-on | Blind | | | | | | | | | | | | | | | |
| 10 | 14 (17.2) | 90 | 16 | - | 16 | 60 | 35 | 25 (28) | 1.8 | 4 | 6 | 40 | 2 | 4 | M12 | 1/2 | " 14 | 0.66 | 0.72 | 0.62 |
| 15 | 20 (21.3) | 95 | 16 | 16 | 16 | 65 | 38 | 30 (32) | 2 | 4 | 6 | 45 | 2 | 4 | M12 | 1/2 " | 14 | 0.76 | 0.81 | 0.74 |
| 20 | 25 (26.9) | 105 | 18 | 18 | 18 | 75 | 40 | 38 (40) | 2.3 | 4 | 6 | 58 | 2 | 4 | M12 | 1/2 | " 14 | 1.06 | 1.24 | 1.05 |
| 25 | 30 (33.7) | 115 | 18 | 18 | 18 | 85 | 40 | 42 (45) | 2.6 | 4 | 6 | 68 | 2 | 4 | M12 | 1/2 " | 14 | 1.3 | 1.38 | 1.31 |
| 32 | 38 (42.4) | 140 | 18 | 18 | 18 | 100 | 42 | 52 (56) | 2.6 | 6 | 6 | 78 | 2 | 4 | M16 | 5/8 | " 18 | 1.88 | 2.03 | 1.82 |
| 40 | 44.5 (48.3) | 150 | 18 | 18 | 18 | 110 | 45 | 60 (64) | 2.6 | 6 | 7 | 88 | 3 | 4 | M16 | 5/8 " | 18 | 2.33 | 2.35 | 2.11 |
| 50 | 57 (60.3) | 165 | 20 | 20 | 20 | 125 | 48 | 72 (75) | 2.9 | 6 | 8 | 102 | 3 | 4 | M16 | 5/8 | " 18 | 2.82 | 3.20 | 2.91 |
| 65 | 76.1 | 185 | 22 | 22 | 22 | 145 | 52 | 90 | 2.9 | 6 | 10 | 122 | 3 | 8 | M16 | 5/8 " | 18 | 3.74 | 4.29 | 4.13 |
| 80 | 88.9 | 200 | 24 | 24 | 24 | 160 | 58 | 105 | 3.2 | 8 | 12 | 138 | 3 | 8 | M16 | 5/8 | " 18 | 4.75 | 5.88 | 5.21 |
| 100 | 108 (114) | 235 | 24 | 24 | 24 | 190 | 65 | 128 (134) | 3.6 | 8 | 12 | 162 | 3 | 8 | M20 | 3/4 " | 23 | 6.52 | 7.54 | 7.08 |
| 125 | 133 (139) | 270 | 26 | 26 | 26 | 220 | 68 | 155 (162) | 4 | 8 | 12 | 188 | 3 | 8 | M24 | 7/8 | 27 | 9.07 | 10.8 | 10.4 |
| 150 | 159 (168) | 300 | 28 | 28 | 28 | 250 | 75 | 182 (192) | 4.5 | 10 | 12 | 218 | 3 | 8 | M24 | 7/8 " | 27 | 11.8 | 14.5 | 13.9 |
| 200 | 216 (219) | 375 | 34 | 34 | 34 | 320 | 88 | 244 | 6.3 | 10 | 16 | 285 | 3 | 12 | M27 | 1 | " 30 | 21.5 | 27.2 | 26.2 |
| 250 | 267 (273) | 450 | 38 | 38 | 38 | 385 | 105 | 298 (306) | 7.1 | 12 | 18 | 345 | 3 | 12 | M30 | 1-1/8 " | 33 | 34.9 | 43.8 | 43.1 |
| 300 | 318 (323) | 515 | 42 | 42 | 42 | 450 | 115 | 362 | 8 | 12 | 18 | 410 | 4 | 16 | M30 | 1-1/8 | " 33 | 49.7 | 63.3 | 62.2 |
| 350 | 368 (355) | 580 | 46 | 46 | 46 | 510 | 125 | 408 | 8.8 | 12 | 20 | 460 | 4 | 16 | M33 | 1-1/4 " | 36 | 68.1 | 89.5 | 87.2 |
| 400 | 419 (406) | 660 | 50 | 50 | 50 | 585 | 135 | 462 | 11 | 12 | 20 | 535 | 4 | 16 | M36 | 1-3/8 | " 39 | 99.7 | 127 | 124 |
| 500 | 521 (508) | 755 | 52 | 52 | 52 | 670 | 140 | 562 | 14.2 | 12 | 20 | 615 | 4 | 20 | M39 | 1-3/8 " | 42 | 117 | 172 | 168 |

* NOTE: Outside diameter of pipe complies with ISO recommendation R64 .

DIN 2636 Welding Neck Flanges

Nominal Pressure 64

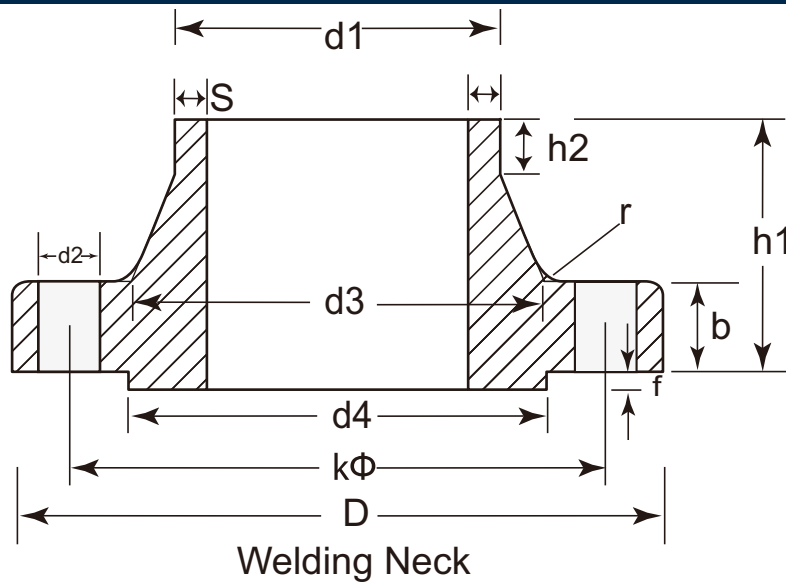

Unit: mm

| Pipe | | Flange | | | | Neck | | | | Raised face | | Bolts | | | Arropx. Weight (kg) | |
|----------|---------------------------|----------------------------------|----------|------------|----------------|--------------------------|------------|----|----------------|----------------|---|-------|--------------|----------------|---------------------|------------|
| DN | d ₁ DIN (ISO)* | D | b | k | h ₁ | d ₃ DIN (ISO) | s | r | h ₂ | d ₄ | f | # | Dia. of Bolt | d ₂ | | |
| 10 to 40 | | See DIN 2637. Rated pressure 100 | | | | | | | | | | | | | | |
| 50 | 57 (60.3) | 180 | 26 | 135 | 62 | 78 (82) | 2.9 | 6 | 10 | 102 | 3 | 4 | M20 | 3/4 " | 22 | 4.5 |
| 65 | 76.1 | 205 | 26 | 160 | 68 | 98 | 3.2 | 6 | 12 | 122 | 3 | 8 | M20 | 3/4 " | " 22 | 5.7 |
| 80 | 88.9 | 215 | 28 | 170 | 72 | 112 | 3.6 | 8 | 12 | 138 | 3 | 8 | M20 | 3/4 " | 22 | 6.7 |
| 100 | 108 (114.3) | 250 | 30 | 200 | 78 | 132 (138) | 4 | 8 | 12 | 162 | 3 | 8 | M24 | 7/8 " | 2 "6 | 9.6 |
| 125 | 133 (139.7) | 295 | 34 | 240 | 88 | 162 (168) | 4.5 | 8 | 12 | 188 | 3 | 8 | M27 | 1 " | 30 | 15.1 |
| 150 | 159 (168.3) | 345 | 36 | 280 | 95 | 192 (202) | 5.6 | 10 | 12 | 215 | 3 | 8 | M30 | 1-1/8 " | 3"3 | 21.9 |
| 175 | 193.7 (219.1) | 375 415 | 40 42 | 310 345 | 105 110 | 228 (256) | 6.3 7.1 | 10 | 16 | 260 285 | 3 | 12 | M30 | 1-1/8 " | 33 | 23.7 35 |
| 250 | 267 (273) | 470 | 46 | 400 | 125 | 310 (316) | 8.8 | 12 | 18 | 345 | 3 | 12 | M33 | 1-1/4 " | 3"6 | 49.6 |
| 300 | 323.9 | 530 | 52 | 460 | 140 | 372 | 11 | 12 | 18 | 410 | 4 | 16 | M33 | 1-1/4 " | 36 | 68.7 |
| 350 | 368 (355.6) | 600 | 56 | 525 | 150 | 420 | 12.5 | 12 | 20 | 465 | 4 | 16 | M36 | 1-3/8 " | " 39 | 94.6 |
| 400 | 419 (406.4) | 670 | 60 | 585 | 160 | 475 | 14.2 | 12 | 20 | 535 | 4 | 16 | M39 | 1-1/2 " | 42 | 124 |

* NOTE: Outside diameter of pipe complies with ISO recommendation R64.

DIN 2637 Welding Neck Flanges Nominal Pressure 100

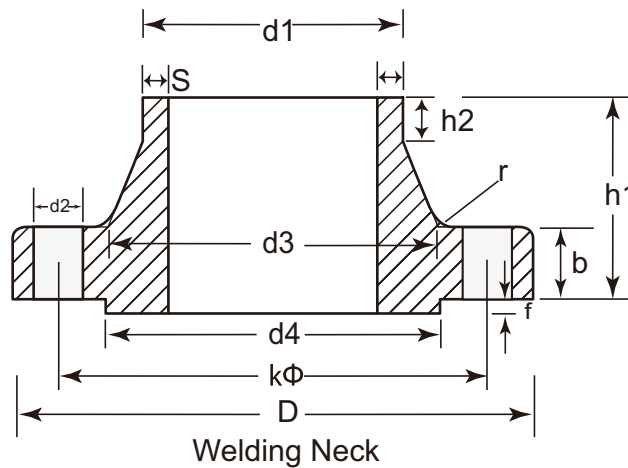

Unit: mm

| Pipe | | Flange | | | | Neck | | | | Raised face | | Bolts | | | Arropx. Weight (kg) | |
|------|---------------------------|--------|----|-----|----------------|--------------------------|------|----|----------------|----------------|---|-------|--------------|----------------|---------------------|------|
| DN | d ₁ DIN (ISO)* | D | b | k | h ₁ | d ₃ DIN (ISO) | s | r | h ₂ | d ₄ | f | # | Dia. of Bolt | d ₂ | | |
| 10 | 14 (17.2) | 100 | 20 | 70 | 45 | 28 (32) | 1.8 | 4 | 6 | 40 | 2 | 4 | M12 | 1/2 | 1*4 | 1.1 |
| 15 | 20 (21.3) | 105 | 20 | 75 | 45 | 32 (34) | 2 | 4 | 6 | 45 | 2 | 4 | M12 | 1/2 " | 14 | 1.2 |
| 25 | 30 (33.7) | 140 | 24 | 100 | 58 | 48 (52) | 2.6 | 4 | 8 | 65 | 2 | 4 | M16 | 5/8 | 1*8 | 2.7 |
| 32 | 38 (42.4) | 155 | 24 | 110 | 60 | 58 (62) | 2.6 | 6 | 8 | 75 | 2 | 4 | M20 | 3/4 " | 23 | 3.2 |
| 40 | 44.5 (48.3) | 170 | 26 | 125 | 62 | 65 (70) | 2.9 | 6 | 10 | 85 | 3 | 4 | M20 | 3/4 " | 23 | 4.1 |
| 50 | 57 (60.3) | 195 | 28 | 145 | 68 | 86 (90) | 3.2 | 6 | 10 | 95 | 3 | 4 | M24 | 7/8 " | 27 | 6 |
| 65 | 76.1 | 220 | 30 | 170 | 76 | 108 | 3.6 | 6 | 12 | 120 | 3 | 8 | M24 | 7/8 " | " 27 | 7.9 |
| 80 | 88.9 | 230 | 32 | 180 | 78 | 120 | 4 | 8 | 12 | 138 | 3 | 8 | M24 | 7/8 " | 27 | 8.9 |
| 100 | 108 (114.3) | 265 | 36 | 210 | 90 | 145 (150) | 5 | 8 | 12 | 162 | 3 | 8 | M27 | 1 | 30 | 13.7 |
| 125 | 133 (139.7) | 315 | 40 | 250 | 105 | 180 | 6.3 | 8 | 12 | 185 | 3 | 8 | M30 | 1-1/8 " | 33 | 22.7 |
| 150 | 159 (168.3) | 355 | 44 | 290 | 115 | 210 | 7.1 | 10 | 12 | 215 | 3 | 12 | M30 | 1-1/8 " | " 33 | 30.2 |
| 175 | 193.7 | 385 | 48 | 320 | 127 | 245 | 8.8 | 10 | 16 | 260 | 3 | 12 | M30 | 1-1/8 " | 33 | 38.9 |
| 200 | 219.1 | 430 | 52 | 360 | 130 | 278 | 10 | 10 | 16 | 280 | 3 | 12 | M33 | 1-1/4 " | 36 | 52.8 |
| 250 | 267 (273) | 505 | 60 | 430 | 157 | 340 | 12.5 | 12 | 18 | 340 | 3 | 12 | M36 | 1-3/8 " | 39 | 81.4 |
| 300 | 323.9 | 585 | 68 | 500 | 170 | 400 | 14.2 | 12 | 18 | 410 | 4 | 16 | M39 | 1-1/2 " | " 42 | 122 |
| 350 | 368 (355.6) | 655 | 74 | 560 | 189 | 460 | 16 | 12 | 20 | 465 | 4 | 16 | M45 | 1-3/4 " | 48 | 165 |

* NOTE: Outside diameter of pipe complies with ISO recommendation R64 .

DIN 2638 Welding Neck Flanges Nominal Pressure 160

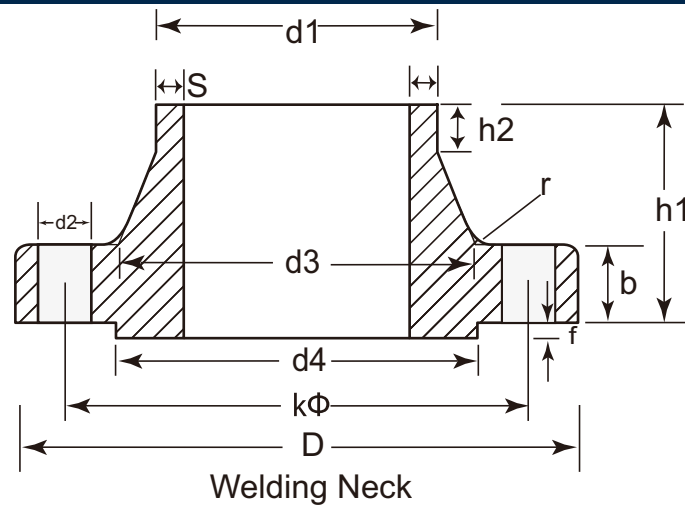

Unit: mm

| Pipe | | Flange | | | | Neck | | | | Raised face | | Bolts | | | Arropx. Weight (kg) | |
|------|---------------------------|--------|-----|-----|----------------|--------------------------|------|----|----------------|----------------|---|-------|--------------|----------------|---------------------|------|
| DN | d ₁ DIN (ISO)* | D | b | k | h ₁ | d ₃ DIN (ISO) | s | r | h ₂ | d ₄ | f | # | Dia. of Bolt | d ₂ | | |
| 10 | 14 (17.2) | 125 | 24 | 85 | 58 | 44 | 2.6 | 4 | 6 | 40 | 2 | 4 | M16 | 5/8 | 1"8 | 2.1 |
| 15 | 20 (21.3) | 130 | 26 | 90 | 60 | 48 | 2.6 | 4 | 6 | 45 | 2 | 4 | M16 | 5/8 " | 18 | 2.5 |
| 25 | 30 (33.7) | 150 | 28 | 105 | 65 | 60 | 3.6 | 4 | 8 | 68 | 2 | 4 | M20 | 3/4 | 1"8 | 3.5 |
| 40 | 44.5 (48.3) | 185 | 34 | 135 | 80 | 84 | 5 | 6 | 10 | 88 | 3 | 4 | M24 | 7/8 " | 26 | 6.5 |
| 50 | 57 (60.3) | 200 | 38 | 150 | 85 | 95 | 6.3 | 6 | 10 | 102 | 3 | 8 | M24 | 7/8 | " 26 | 7.9 |
| 65 | 76.1 | 230 | 42 | 180 | 95 | 124 | 8 | 6 | 12 | 122 | 3 | 8 | M24 | 7/8 " | 26 | 12 |
| 80 | 101.6 | 255 | 46 | 200 | 102 | 136 | 11 | 8 | 12 | 138 | 3 | 8 | M27 | 1 | " 30 | 16 |
| 100 | 127 | 300 | 54 | 235 | 120 | 164 | 14.2 | 8 | 14 | 162 | 3 | 8 | M30 | 1-1/8 " | 33 | 26.3 |
| 125 | 152.4 | 340 | 60 | 275 | 140 | 200 | 16 | 8 | 16 | 188 | 3 | 12 | M30 | 1-1/8 | " 33 | 37.8 |
| 150 | 177.8 | 390 | 68 | 320 | 160 | 240 | 17.5 | 10 | 18 | 218 | 3 | 12 | M33 | 1-1/4 " | 36 | 58 |
| 200 | 244.5 | 485 | 82 | 400 | 190 | 305 | 25 | 10 | 25 | 285 | 3 | 12 | M39 | 1-1/2 | " 42 | 105 |
| 250 | 298.5 | 585 | 100 | 490 | 215 | 385 | 32 | 12 | 30 | 345 | 3 | 16 | M45 | 2-1/8 " | 48 | 182 |

* NOTE: Outside diameter of pipe complies with ISO recommendation R64 .

DIN 2633 Welding Neck Flanges
 DIN 2543 Slip-on Flanges
 DIN 2527 Blind Flanges
Nominal Pressure 160

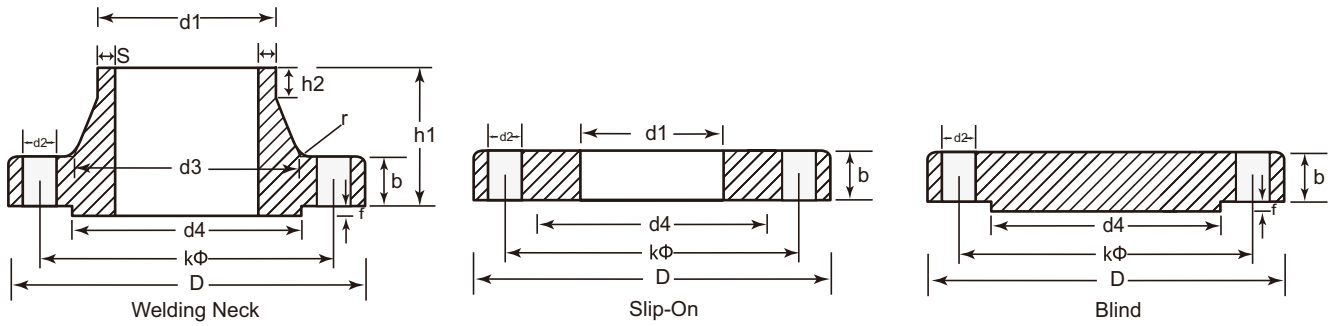

Unit: mm

| Pipe | | Flange | | | | | Neck | | | | Raised Face | | Bolts | | | Arropx. Weight (kg) | | | | |
|------|---------------------------------|--------|-----------------|---------|-------|-----|----------------|--------------------------------|-----|----|----------------|----------------|-------|----|--------------|---------------------|----------------------|--------------|-------|------|
| DN | d ₁ DIN (ISO)* | D | b | | | k | h ₁ | d ₃ DIN (ISO) | s | r | h ₂ | d ₄ | f | # | Dia. of Bolt | d ₂ | Weld- ing Nack | Slip- on | Blind | |
| | | | Welding Nack | Slip-on | Blind | | | | | | | | | | | | | | | |
| 10 | 14 (17.2) | 90 | 14 | - | 14 | 60 | 35 | 25 (28) | 1.8 | 4 | 6 | 40 | 2 | 4 | M12 | 1/2 | " 14 | 0.58 | 0.63 | 0.56 |
| 15 | 20 (21.3) | 95 | 14 | 14 | 14 | 65 | 35 | 30 (32) | 2 | 4 | 6 | 45 | 2 | 4 | M12 | 1/2 | " 14 | 0.65 | 0.72 | 0.64 |
| 20 | 25 (26.9) | 105 | 16 | 16 | 16 | 75 | 38 | 38 (40) | 2.3 | 4 | 6 | 58 | 2 | 4 | M12 | 1/2 | " 14 | 0.95 | 1.01 | 0.93 |
| 25 | 30 (33.7) | 115 | 16 | 16 | 16 | 85 | 38 | 42 (45) | 2.6 | 4 | 6 | 68 | 2 | 4 | M12 | 1/2 | " 14 | 1.14 | 1.23 | 1.13 |
| 32 | 38 (42.4) | 140 | 16 | 16 | 16 | 100 | 40 | 52 (56) | 2.6 | 6 | 6 | 78 | 2 | 4 | M16 | 5/8 | " 18 | 1.69 | 1.80 | 1.66 |
| 40 | 44.5 (48.3) | 150 | 16 | 16 | 16 | 110 | 42 | 60 (64) | 2.6 | 6 | 7 | 88 | 3 | 4 | M16 | 5/8 | " 18 | 1.86 | 2.09 | 1.85 |
| 50 | 57 (60.3) | 165 | 18 | 18 | 18 | 125 | 45 | 72 (75) | 2.9 | 6 | 8 | 102 | 3 | 4 | M16 | 5/8 | " 18 | 2.53 | 2.88 | 2.59 |
| 65 | 76.1 | 185 | 18 | 18 | 18 | 145 | 45 | 90 | 2.9 | 6 | 10 | 122 | 3 | 4 | M16 | 5/8 | " 18 | 3.06 | 3.66 | 3.33 |
| 80 | 88.9 | 200 | 20 | 20 | 20 | 160 | 50 | 105 | 3.2 | 8 | 10 | 138 | 3 | 8 | M16 | 5/8 | " 18 | 3.70 | 4.77 | 4.34 |
| 100 | 108 (114) | 220 | 20 | 20 | 20 | 180 | 52 | 125 (131) | 3.6 | 8 | 12 | 158 | 3 | 8 | M16 | 5/8 | " 18 | 4.62 | 5.65 | 5.26 |
| 125 | 133 (139) | 250 | 22 | 22 | 22 | 210 | 55 | 150 (156) | 4 | 8 | 12 | 188 | 3 | 8 | M16 | 5/8 | " 18 | 6.30 | 8.42 | 7.67 |
| 150 | 159 (168) | 285 | 22 | 22 | 22 | 240 | 55 | 175 (184) | 4.5 | 10 | 12 | 212 | 3 | 8 | M20 | 3/4 | " 23 | 7.75 | 10.4 | 9.85 |
| 200 | 216 (219) | 340 | 24 | 24 | 24 | 295 | 62 | 235 | 5.9 | 10 | 16 | 268 | 3 | 12 | M20 | 3/4 | " 23 | 11.0 | 16.1 | 15.6 |
| 250 | 267 (273) | 405 | 26 | 26 | 26 | 355 | 70 | 285 (292) | 6.3 | 12 | 16 | 320 | 3 | 12 | M24 | 7/8 | " 27 | 15.6 | 24.9 | 23.9 |
| 300 | 318 (323) | 460 | 28 | 28 | 28 | 410 | 78 | 344 | 7.1 | 12 | 16 | 378 | 4 | 12 | M24 | 7/8 | " 27 | 22.0 | 35.1 | 33.6 |
| 350 | 368 (355) | 520 | 30 | 30 | 30 | 470 | 82 | 390 | 8 | 12 | 16 | 438 | 4 | 16 | M24 | 7/8 | " 27 | 28.7 31.0 | 47.8 | 46.2 |
| 400 | 419 (406) | 580 | 32 | 32 | 32 | 525 | 85 | 445 | 8 | 12 | 16 | 490 | 4 | 16 | M27 | 1 | " 30 | 36.3 39.3 | 63.5 | 61.5 |
| 500 | 521 (508) | 715 | 34 | 36 | 34 | 650 | 90 | 548 | 8 | 12 | 16 | 610 | 4 | 20 | M30 | 1-1/8 | " 33 | 61.0 | 102.0 | 99.5 |
| 600 | 622 (609) | 840 | 36 | 40 | - | 770 | 95 | 652 | 8 | 12 | 18 | 725 | 5 | 20 | M33 | 1-1/4 | " 36 | 75.4 | - | - |

* NOTE: Outside diameter of pipe complies with ISO recommendation R64.

■ The manufacturer does not accept any responsibility for any typing or printing errors in this catalog. It also reserves the right to make any alterations or modifications deemed necessary at any time, without altering or interfering with the basic functions of the apparatus.

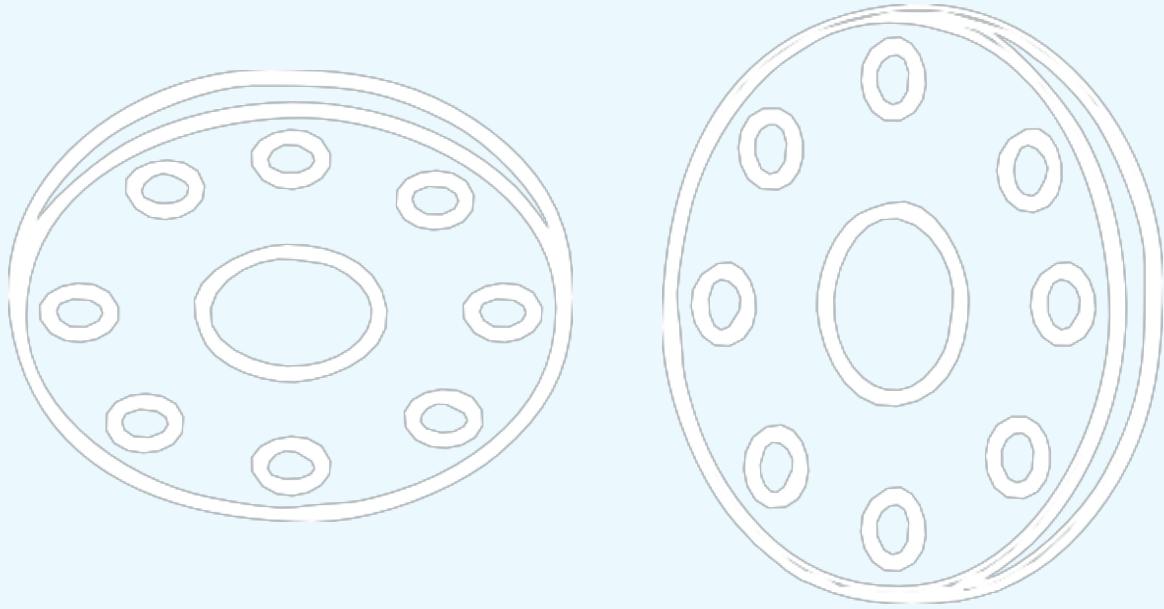

cod. 979665 - I.P. 10.000 Copyright by Goval Italy - Tutti i diritti riservati. All rights reserved.

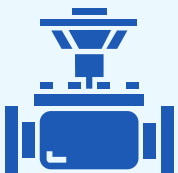

GOVAL
I T A L Y 

Goval Italy S.r.l
Via I Maggio 13 - 20090 ,
Segrate, Milano,
Italy.

+39 334 710 5173
goval@govalit.com
www.govalit.com